

# GWL/ Power Group Technology Solutions – Stay Powered for the Future

## HZJ 200S-48V + auxiliary contact



### Brief technical data

	Type and parameters	Coil & Rated voltage of contact circuit (V)								
		6	12	24	30	36	40	48	72	80
1	Coil power dissipation $\leq 15$ (w), Max. Coil current (a)	0.95	0.8	0.3	0.25	0.2	0.18	0.21	0.1	0.08
2	Main contact rated current	Resistive load: $t=1$ ms, 200A Max. Rated permissible current to contact circuit for 4e.5 seconds								
3	Dielectric (volt) strength	50Hz 1000 V AC 1min								
4	operating time	Pickup (contact makes) $\leq 30$ ms, release (contact breaks) $\leq 30$ ms								
5	Action characteristic	Pickup (contact makes) $\leq 66\% U_s$ Release (contact breaks): $\leq 30\% U_s, \leq 5\% U_s$								
6	Mechanical life	300 thousand times								
7	Electric life	Resistive load ( $t=1$ ms) 50000 times inductive load (DC-5): 60% I <sub>F</sub> resistive load 20000 times								

### Configurational mounting diagram

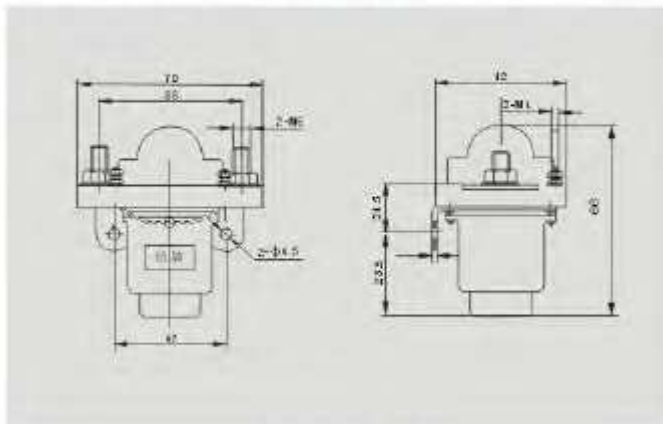

### Circuit diagram

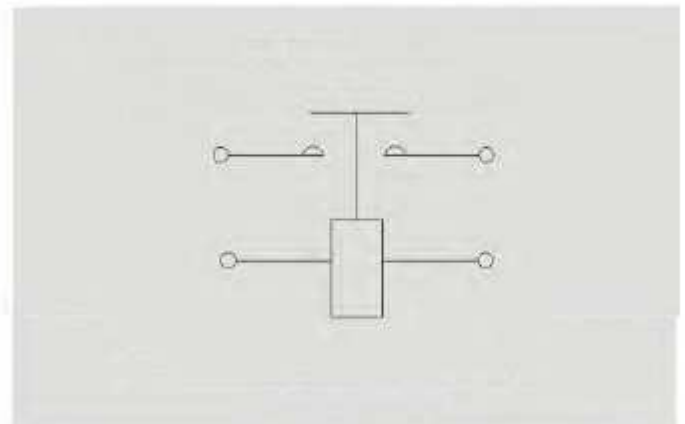

### Environmental condition

- 1、 Ambient temperature:  $-25 \sim +40^{\circ}\text{C}$
- 2、 Altitude range: 0-2000m
- 3、 Max. relative humidity 90% at  $20^{\circ}\text{C}$
- 4、 Vibration: 10~50Hz,  $10\text{m}/\text{S}^2$
- 5、 Shock resistance:  $30\text{m}/\text{s}^2$
- 6、 Attitude: anywhere
- 7、 Power voltage fluctuating:  $(0.7 \sim 1.1) U_e$
- 8、 Duty: 8h continuous

## Nomination(nomogram)

